

HASCONWING® C-ALU

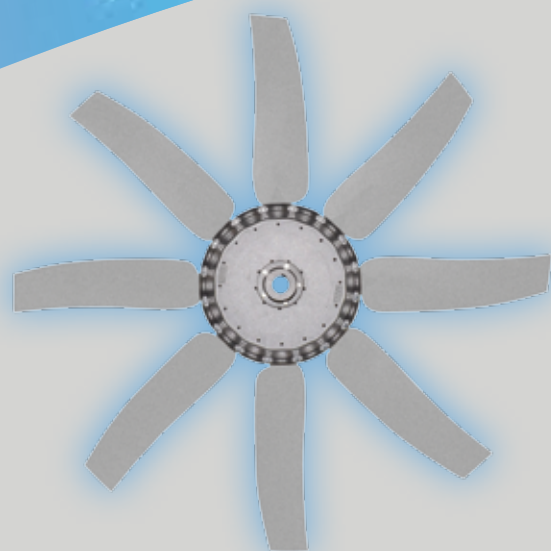
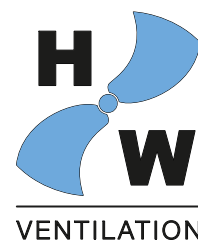

Variable airfoil profile axial impellers in aluminum up to Ø 1280 mm

> Product features

HasconWing® C-ALU impellers are conceived as an evolution of the HV series. The shape of the new series has been designed to produce higher airflow rates, while ensuring better efficiency and lower noise emission levels. C-ALU impellers are thought to be employed in high-temperature environments and are manufactured assembling airfoil profile blades made of aluminum, with a light aluminum alloy hub. The impellers are available in configurations with 5/9/12/16 blades. Blades are available in two models: regular (CL) and short (CL-S) blades, with left setting angles ranging from 25° to 50° and producing a sucking or blowing air flow.



> Applications

- VENTILATORS
- RADIATORS
- GENERATORS
- SNOW CANNONS
- HIGH TEMPERATURES
- DRYERS AND KILNS
- TUNNELS
- COOLING TOWERS

> Highlights

- **QUALIFYFAN** v.1.0 free fan selection software is available for download at www.hwventilation.it
- **ErP 2015** READY our fans are tested in **AMCA 210/07** wind tunnel and comply with EU Directive 2015
- **HIGHER** airflow rates at high operating temperatures
- **BETTER** efficiency, more energy savings through improved design
- **LOW NOISE** emission levels (data available upon request)

>Specifications

HasconWing® C-ALU impellers are configurable with 5/9/12/16 blades. Blades are available in two models: regular (CL), and short (CL-S) with left setting angles ranging from 25° to 50°.

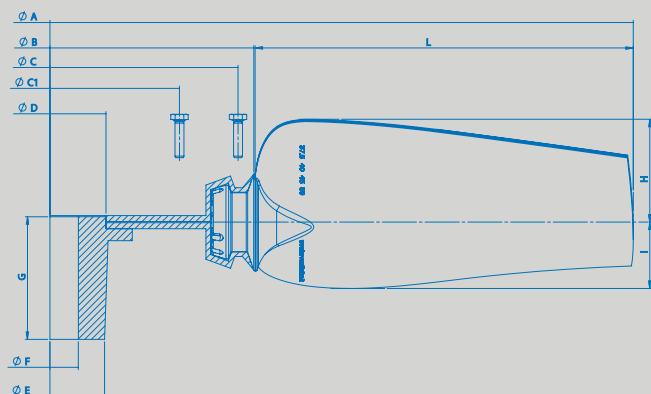

	CL-S	CL
A= chords	135	135
B= length	328	456
Max ø impellers	1030	1280

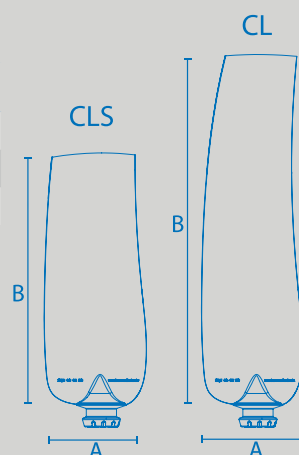

BLADE n°	BLADE Type	max ø A mm	ø B mm	ø C mm	n° holes ø C	ø C ¹ *** mm	n° holes ø C ¹	ø D mm	ø E mm	ø F mm	G mm
5	CLS	796	158	139	5 Ø 6,5	-	-	55	44-52	14 ÷ 34	0-42-62
	CL	1050									
9*	CLS	846	202	184	9 Ø 6,5	110	9 Ø 6,5	75-95	45-51-73 95	14 ÷ 42	0-42-52 62-82-112
	CL	1100									
12*	CLS	926	280	264	12 Ø 6,5	185	12 Ø 6,5	75-170	45-51-73 95	14 ÷ 42	0-42-52 62-82-112
	CL	1180									
16**	CLS	1026	375	358	16 Ø 6,5	280	16 Ø 6,5	75-240	45-51-73 95	14 ÷ 55	0-42-52 62-82-112
	CL	1280									

* nr 5 Ø 6,5 holes on Ø 90 for interchangeable boss connections

** nr 5 Ø 6,5 holes on Ø 90 and nr 9 Ø 6,5 holes on Ø 110 for interchangeable boss connections

*** only for medium or total tightening

>Materials

HasconWing® C-ALU blades are 100% made of aluminum, ensuring the best performances in high-temperature environments

MATERIAL	DESCRIPTION	STD. COLOR	OP. TEMPERATURE*
ALU	Aluminum	-	-80°C to +250°C

*Contact technical dpt. for customized advise

ISO 9001 certified company